

Benefits of the Litera Create Architecture

Overview

Litera Create is a services-based document creation platform designed to help legal professionals create better documents with enterprise-wide templates and a content library. As the successor to Innova, Forte, and Content Companion, Litera Create's SaaS architecture moves the burden of document creation out of Word and off the desktop. This web architecture takes advantage of modern SaaS technology, methods and deployments.

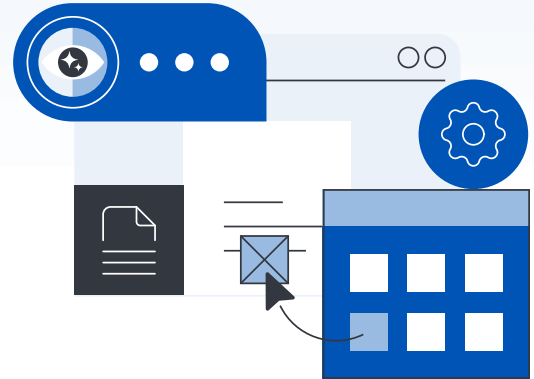

The benefits of Litera Create's architecture are numerous and include:

- Vendor maintained infrastructure
- Azure security tools for all environments
- Faster remediation of security threats, environment patching and resolution of application bugs
- Freeing of customer IT teams to focus on other applications
- Consistently being on the most recent, fully supported version of the Litera Create application



Performance

The Litera Create architecture ensures the performance of creating documents is orders of magnitude better than creating documents in desktop Word. A services-based architecture allows for easy vertical and horizontal scaling to improve performance in both small and large firm environments.



Product Deployment and Upgrade

Deploying Litera Create is significantly simpler using the Litera Hosted model. Our team deploys the entire backend of Litera Create, including all necessary security and database components, reducing the time and effort for your IT teams to deploy and update the platform. Litera Create is deployed into Microsoft Azure single tenant environments, in a data center selected by your firm at the time of purchase.



LITERA
Create

The benefits of allowing Litera to host your Litera Create instance ensure that the process of upgrading, patching, and maintaining your environment is easy, fast, and convenient. Litera currently performs upgrades on a quarterly schedule, which means we upgrade the backend infrastructure during off-peak times and provides a download to the latest desktop clients for customers to download the package and distribute to their end users. This process ultimately eliminates the need for your internal IT teams to maintain and manage the Create infrastructure.

Leveraging a server-side architecture in Litera Create removes the need to sync updates down to or deploy heavy engines to local machines. This means that your firm only needs to deploy the light Word add-in to local machines. Litera ensures that the desktop client component which still needs to be deployed to local machines is tested and is backwards compatible at least one version back.



Content and Customization Deployment and Upgrade

Given content and customization is maintained by the set of the Litera Create services, there is no need to distribute updated templates and associated preferences.

The creation and update of new templates, signatures, letterhead, litigation documents, or any other content exposed by the product is handled without any need to deploy files to each desktop. Similarly, access permissions and restrictions do not involve any file or data distribution. The same holds true for integration with external data and content providers; all configuration or change of configuration is handled through an administrative interface that does not alter the user desktop.



Security

Because Litera Create content, templates, and client-matter data are not stored on the desktop, security vulnerabilities are minimized.

Access to product content and data is controlled via authentication through the customer Azure AD IDP, ensuring that only authorized users can access Litera Create.

Each Litera Create environment is a dedicated, single tenant instance, ensuring that only the firm's users can make requests and that all data stored is specific to your environment and cannot be accessed by other Litera Create customers.

Litera also deploys multiple security layers, including application gateways, Azure firewalls and DDoS protections. Finally, every environment is monitored 24/7 by Litera's security teams, ensuring that in the case of a security threat, the issue is remediated immediately.

For a closer look, visit www.litera.com or [request a demo](#).